



Industrial design patent No.: CN 200830300492.1
Please read this manual before operating

UDS-P LED ULTRASONIC SCALER

INSTRUCTION MANUAL



www.glwoodpecker.com

GUILIN WOODPECKER MEDICAL INSTRUMENT CO., LTD.

Contents

1. The installation and components of equipment	1
2. Product function and operation	4
3. Sterilization and maintenance	7
4. Precaution	10
5. After service	12
6. Symbol instruction	12
7. Environmental protection	13
8. Manufacturer's right	13
9. European authorized representative	13
10. EMC-Declaration of conformity	14
11. Statement	17
TABLE OF OPERATING POWER OF THE TIPS	18

1. The installation and components of equipment

1.1 Instruction

Guilin Woodpecker Medical Instrument Co., Ltd. is a professional manufacturer in researching, developing and producing ultrasonic scalers. The product is mainly used for teeth cleaning and is also an indispensable equipment for teeth disease prevention and treatment. The product UDS-P LED ultrasonic scaler has scaling, perio and endo functions. It contains the following features:

1.1.1 Optical handpiece, more convenient for clinical operation.

1.1.2 Automatic frequency tracking ensures that the machine always works on the best frequency and performs more steadily.

1.1.3 The handpiece is detachable and can be autoclaved to the high temperature of 134°C and the pressure of 0.22MPa.

1.1.4 Digitally controlled, easy operation and more efficient for scaling.

These features make UDS-P LED become a new generation product in the world dental market.

1.2 Components

1.2.1 The components of machine are listed in the packing list.

1.2.2 Product performance and structure

Ultrasonic scaler is composed of electro circuit, water way and ultrasonic transducer.

1.2.3 Scope of application

Ultrasonic scaler UDS-P LED is used for the dental calculus elimination and root canal treatment.

1.3 The main technical specifications

1.3.1 Power supply input: 220-240V~ 50Hz/60Hz 150mA

1.3.2 Main unit input: 24V~ 50Hz/60Hz 1.3A

1.3.3 Output primary tip Vibration excursion: $\leq 100\mu\text{m}$

1.3.4 Output half-excursion force: $< 2\text{N}$

1.3.5 Output tip Vibration frequency: $28\text{kHz}\pm 3\text{kHz}$

1.3.6 Output power: 3W to 20W

1.3.7 Main unit fuse: T1.6AL 250V

1.3.8 Power supply fuse: T0.5AL 250V

1.3.9 Water pressure: 0.1bar to 5bar (0.01MPa to 0.5MPa)

1.3.10 Weight of main unit: 0.68kg

1.3.11 Weight of power supply: 1 kg

1.3.12 Operating mode: Continuous operation

1.3.13 Type of protection against electric shock: Class II

1.3.14 Degree of protection against electric shock: Type BF applied part

1.3.15 Degree of protection against harmful ingress of water: Ordinary equipment (IPX0), Protection degree against water (used on foot switch): IPX1

1.3.16 Applied part of the equipment: handpiece and tip

1.3.17 Degree of safety of application in the presence of a Flammable Anesthetic Mixture with air or with Oxygen or Nitrous Oxide: Equipment not suitable for being used in the presence of a flammable anaesthetic mixture with air or with oxygen or nitrous oxide

1.4 Installation of the main components

Sketch map for installation and connection.

1.4.1. The components of the equipment are showed in picture 1(a, b)

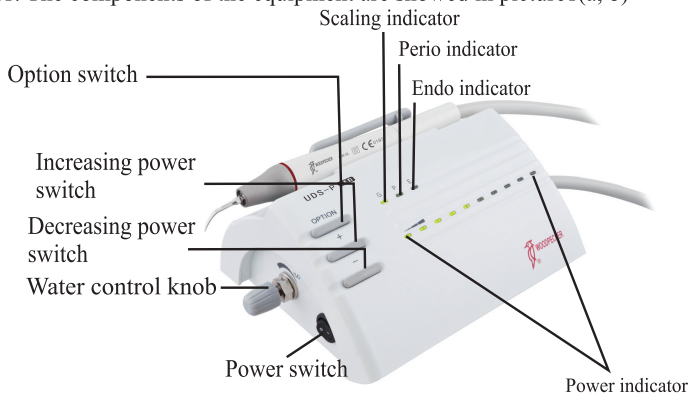

picture 1(a)
Handpeice

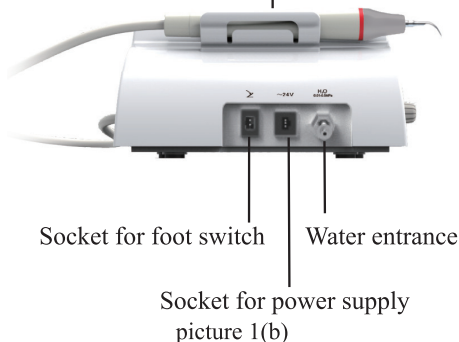

picture 1(b)

1.4.2. Sketch map for connection of foot switch, power supply and main unit are showed in picture 2

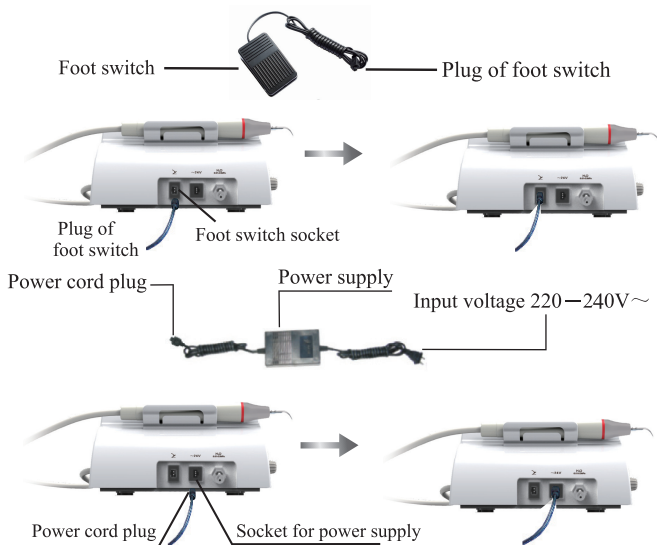

picture 2

1.4.3. Sketch map for connection of water supply system are showed in picture3.

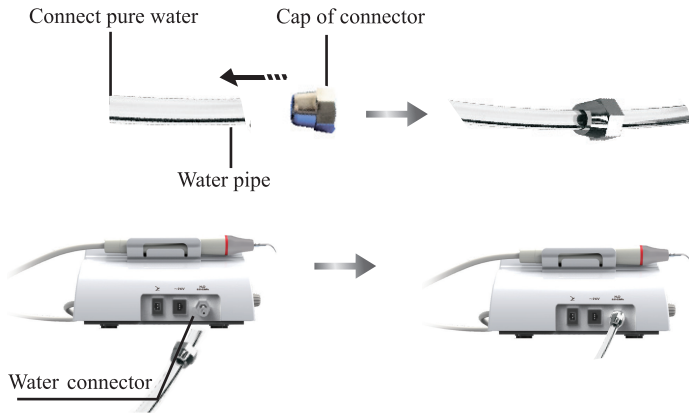

picture 3

1.4.4 Sketch map for connection of detachable handpiece are showed in picture4.

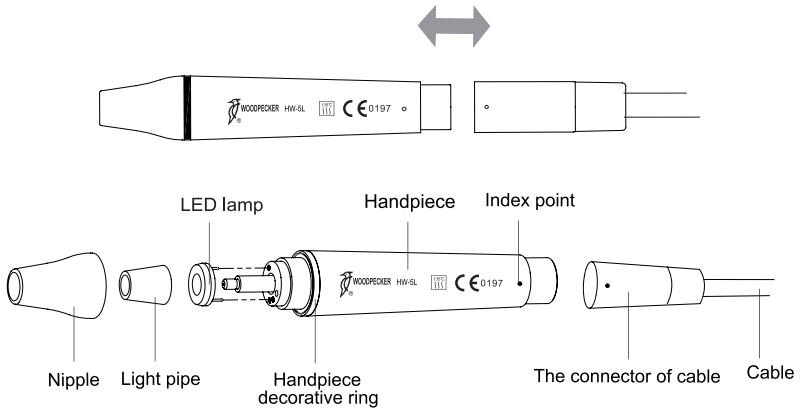

picture 4

1.4.5 Sketch map for how to install tip and endochuck with wrench are showed in picture5.

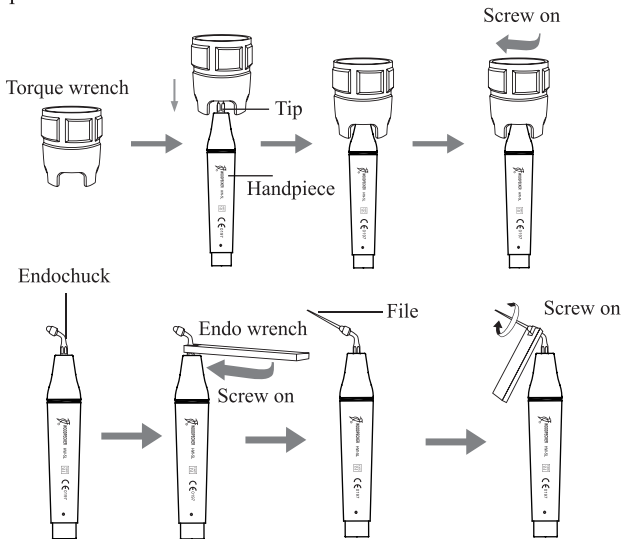

picture 5

2. Product function and operation

2.1 Scaling function

2.1.1 Operation

a) Open the packing box, make sure that all the parts and accessories are

complete according to the packing list. Take the main unit out of the box and put it on a stable plane.

b) Turn the water control switch to the max based on symbol as shown as 3.5.2 [note 1].

c) Insert the plug of the foot switch to its socket (picture 2).

d) Connect one end of the water pipe to the water entrance, and the other end to the pure water source (picture 3).

e) Select a suitable scaling tip as you need, screw it on the handpiece tightly by the torque wrench (picture 5), then connect the handpiece and the connector of cable correctly.

f) Insert the plug of the power supply to its socket, then get through to the power (picture 2).

g) Switch on the main unit, then the scaling indicator and the first five lights of power regulator shine.

h) Step on the foot switch, the tip begins to vibrate, and the LED lamp on the top of the handpiece shines. Release the foot switch, the LED lamp keep shining for 10 seconds.

i) The normal frequency is extremely high. Under the normal working state of scaling tips, a light touch and a certain to-and-fro motion will eliminate the tartar without heating. Overexertion and long-time lingering are forbidden.

j) Vibrating intensity: Adjust the vibration intensity as you need, generally turn the knob to the middle grade. According to patients

k) During the clinical treatment, be sure not to make the end of tip touch the teeth vertically and not to make the tip overexert on the surface of the teeth in case of hurting the teeth and damaging the tip.

l) After finishing operation, keep the machine working for 30 seconds on the water supply condition in order to clean the handpiece and the scaling tip.

m) Unscrew the scaling tip and pull out handpiece, then sterilize them.

Notice: Don't pull out the handpiece when the machine is working.

2.1.2 Instruction for main components of detachable handpiece (showed in picture 4).

a) Nipple: The nipple can be removed. You can screw off the nipple and clean the pole with alcohol termly.

b) Decorative ring: can be disassembled and cleaned with alcohol regularly, can be autoclaved under the high temperature and pressure.

c) Handpiece: The main part of the whole handpiece, can be autoclaved under the high temperature and pressure.

d) The connector of the cable: Connect the handpiece with the water source and power supply of the main unit.

e) LED lamp、Light pipe: Clean them with purified water and sterilize them under the high temperature of 134°C and high pressure of 0.22Mpa.

Notice: Keep the connector dry.

2.1.3 Torque wrench instruction (showed in picture 5)

a) The torque wrench's structure is designed in special way which can control the strength of the scaling tip' s installation properly and correctly. It also can guarantee the operator screw or unscrew the scaling tip effectively and keep their hands away from being scratched.

b) Operation

- ① Take the scaling tip into the torque wrench; operate as showed in picture 5.
- ② Tip installation: Hold the handpiece turn the tip toward direction as showed in picture 5 with the torque wrench. Turn two more circles when the tip stops, then the tip is installed.
- ③ Tip uninstallation: Hold the handpiece, turn the wrench toward anti-clockwise direction.
- ④ Sterilize it in sterilizer after each treatment.
- ⑤ The torque wrench must be cooled naturally after sterilization to avoiding scalding when using next time.
- ⑥ Keep the torque wrench in a cool, dry and ventilated place and keep it clean.

c) Precaution

The following sterilizing methods are forbidden.

- ① Soaked in solution.
- ② Dip in iodine, alcohol or glutaraldehyde;
- ③ Torrefy in oven or microwave oven.

Notice: we are not responsible for any damage of the torque wrench directly or indirectly made by any way in the above items.

2.2 Endo function

2.2.1 Usage process

- a) Fix endochuck to handpiece by endo wrench.
- b) Unscrew the screw cap on the endochuck.
- c) Put the ultrasonic file into the hole in the front of endochuck.
- d) Screw down the screw cap with endo wrench to tight up the ultrasonic file.
- e) Press option key, turn to endo function.
- f) When ultrasonic scaler turns into endo function, only the first lead light is on and the power is at first grade. Put the ultrasonic file into the patient's root canal slowly, step on the foot switch, then make endo treatment. During the treatment, turn up the power gradually according to the needs.

2.2.2 Notice

- a) **When fixing endochuck, it must be screwed down.**
- b) **The screw cap on the endochuck must be screwed down.**
- c) **Don't press it too hard when the ultrasonic file is in the root canal.**
- d) **Don't step on the foot switch until the ultrasonic file is in the root canal.**
- e) **The power range is supposed from 1st to 5th grade.**

3. Sterilization and maintenance

3.1 Sterilization of detachable handpiece

3.1.1 Autoclaved under high temperature, pressure, time:

- a) 134°C, 2.0bar~2.3bar (0.20MPa~0.23MPa), 4min.
- b) Pull out the handpiece and unscrew the scaling tip and endochuck after each operation.
- c) Pack the handpiece with sterile gauze or sterile bag before sterilizing.
- d) Reuse handpiece after it cools naturally in case of scalding hand.

3.1.2 Notice

a) Clear the cleaning liquid on the handpiece with compressed air before sterilization.

b) Be sure that the scaling tip has been unscrewed from the handpiece and it can not be sterilized with others.

c) Please notice whether the outer of the handpiece is damaged during the treatment or sterilization, don't smear any protective oil on the surface of handpiece.

d) There are two waterproof "O" rings at the end of handpiece. Please lubricate them with dental lube frequently, as sterilization and repeated pulling and inserting will reduce their life-span. Change a new one once it is damaged or worn excessively.

e) The following sterilizing methods are forbidden:

- ① **Put handpiece into any liquid for boiling.**
- ② **Dip handpiece in disinfectors such as iodine, alcohol and glutaraldehyde.**
- ③ **Put handpiece into oven or microwave oven for baking.**

3.2 Sterilization of scaling tips and endochuck

All the scaling tips and endochuck can be autoclaved to 134°C.

3.3 Sterilization of torque wrench and endo wrench

3.3.1 The torque wrench and endo wrench can be sterilized in high temperature and pressure.

3.3.2 The following sterilization ways for torque wrench are forbidden:

- a) Soaked in solution.
- b) Dip in iodine, alcohol or glutaraldehyde.
- c) Torrefy in oven or microwave oven.

Notice: We are not responsible for any damage of the torque wrench directly or indirectly made by any way in the above items.

3.4 Cleaning of tips, endochuck, torque wrench and endo wrench

The scaling tip, endochuck, torque wrench and endo wrench can be cleaned

by ultrasonic cleaner.

3.5 Sterilization and cleaning of LED lamp and Light pipe

Clean the LED lamp and Light pipe with purified water and sterilize them under high temperature and high pressure after every operation.

3.6 Troubleshooting and notes

3.6.1 Troubleshooting

Fault	Possible causes	Solutions
The scaling tip doesn't vibrate and there is no water flowing out when stepping on the foot switch.	The power pipe plug is in loose connect.	Connect the power plug well.
	The foot switch is in loose.	Insert the foot switch to its socket tightly.
	The fuse in the main unit is broken.	Contact our dealers or us.
The scaling tip doesn't vibrate but there is water flowing out when stepping on the foot switch.	The tip is in loose.	Screw the tip on the handpiece tightly (picture 5).
	The connect plug of the handpiece with the circuit board is in loose connect.	Contact our dealers or us.
The scaling tip doesn't vibrate but there is water flowing out when stepping on the foot switch.	Something wrong with the handpiece.	Send it to our company to repair.
	Something wrong with the cable.	Contact our dealers or us.
The scaling tip vibrates but there is no spray when stepping on the foot switch.	The water control switch is not on.	Turn on the water control switch [note 1].
	There is impurity in the solenoid valve.	Contact our dealers or us.
	The water system is blocked.	Clean the water pipe by multi-function syringe [note 2].

Fault	Possible causes	Solutions
There is still water flowing out after the power is off.	There is impurity in the solenoid valve.	Contact our dealers or us.
The handpiece generates heat.	The water control switch is in a low setting.	Turn the water control switch to a higher grade [note 2].
The amount of spouting water is too little.	The water pressure is not high enough.	Make the water pressure higher.
	The water pipe is blocked.	Clean the water pipe by multi-function syringe [note 2].
The vibration of the tip becomes weak.	The tip hasn't been screwed on to the handpiece tightly.	Screw the tip on the handpiece tightly(as showed in picture 5)
	The tip is loose because of vibration.	Screw on the tip tightly (as showed in picture 5).
	The coupling between the handpiece and the cable isn't dry.	Dry it by the hot air.
The vibration of the tip becomes weak.	The tip is damaged [note 3]	Change a new one.
There is water seeping from the coupling between the handpiece and the cable.	The waterproof "O" ring is damaged.	Change a new "O" ring.
The u-file doesn't vibrate.	The screw cap is loose.	Tighten it.
	Endochuck is damaged.	Change a new one.
There is noise coming from the endochuck	The screw cap is loose.	Tighten it.

If the problem still can't be solved, please contact with local dealer or manufacturer.

3.6.2 Notes

[Note 1] Turn water control knob can adjust water volume according to the symbol.

[Note 2] Clean the water pipe with the multi-function syringe of the dental unit (as showed in picture 6):



picture 6

- a) Cut the water pipe at a distance of 10cm to 20cm from the water entrance.
- b) Turn on the electricity and get through the electricity.
- c) Connect the multi-function syringe of dental unit to the water pipe.
- d) Disassemble the tip or handpiece.
- e) Step on the foot switch.
- f) Turn on the switch of the multi-function syringe, press the water into the machine and the impurity blocked in the water pipe can be eliminated.

[Note 3] If the scaling tip has been screwed on tightly and there is fine spray too, the following phenomena show that the scaling tip is damaged:

a) The vibrating intensity and the water atomization degree become weak obviously.

b) During treatment, it produces the sound like "buzz" from the scaling tip.

4. Precaution

4.1 Notice when using equipment

4.1.1 Keep the scaler clean before and after operation.

4.1.2 The handpiece, scaling tip, torque wrench, endo wrench and endochuck must be sterilized before every treatment.

4.1.3 Don't screw the handpiece, scaling tip and endochuck when stepping on the foot switch.

4.1.4 The scaling tip must be fastened and there must be fine spray or drip coming out from the tip when operating.

4.1.5 Change a new one when the tip and ultrasonic file are damaged or worn excessively.

4.1.6 While scaler working ,the heat of scaling tip will become higher if there is no water flowing out.Please keep the water flow smoothly.

4.1.7 Don't twist or rub the tip and endochuck.

4.1.8 Don't use impure water source and be sure not use normal brine instead of pure water source.

4.1.9 If use the water source without pressure, the water surface should be one meter higher than the head of the patient.

4.1.10 Keep the connector of handpiece and the socket of the cable dry before installing the handpiece.

4.1.11 Don't pull the cable forcibly in case of the handpiece falling off from the cable.

4.1.12 Don't knock or rub the handpiece.

4.1.13 After operation, turn off the power, then pull out the plug.

4.1.14 We are only responsible for the safety on the following conditions:

a) The maintenance, repair and modification are made by the manufacturer or the authorized dealer.

b) The changed components are original of "Woodpecker" and operated according to instruction manual.

4.1.15 Please put the power plug into the socket easy to pull out, to make sure it can be pull out in emergency.

4.1.16 The power supply is considered as a part of ME equipment. This device can only be equipped with the special power supply of Guilin Woodpecker Medical Instrument Co., Ltd.

4.1.17 The power supply is NOT waterproof. Please keep it dry and away from the water.

4.1.18 The internal screw thread of the scaling tips produced by some manufacturers maybe coarse, rusty and collapsed. This will damage the external screw thread of the handpiece irretrievably. Please use "Woodpecker" brand scaling tips.

4.1.19 This model is only matched the power supply of our company.

4.1.20 Please select a suitable power when using different type of tips (refer to "TABLE OF OPERATING POWER OF THE TIPS").

4.2 Contraindication

4.2.1 The hemophilia disease patient is not allowed to use this equipment.

4.2.2 The patients or doctors with heart pacemaker are forbidden to use this equipment.

4.2.3 The heart disease patient, pregnant woman and children should be cautious to use the equipment.

4.3 Storage and maintenance

4.3.1 The equipment should be handled carefully and lightly. Be sure that it is far from the vibration, and is installed or kept in a cool, dry and ventilated place.

4.3.2 Don't store the machine together with the articles that are combustible, poisonous, caustic, or explosive.

4.3.3 This equipment should be stored in a room where the relative humidity

is 10% ~ 93%, atmospheric pressure is 70kPa to 106kPa, and the temperature is -20°C ~ +55°C.

4.3.4 If the machine is not used for a long time, please make it get through the power and water once per month for five minutes.

4.4 Transportation

4.4.1 Excessive impact and shake should be prevented in transportation. Lay it carefully and lightly and don't invert it.

4.4.2 Don't put it together with dangerous goods during transportation.

4.4.3 Avoid solarization and getting wet in rain or snow during transportation.

4.5 Working condition

4.5.1 Environment temperature: +5°C to +40°C

4.5.2 Relative humidity: 30% ~75%

4.5.3 Atmosphere pressure: 70kPa to 106kPa

4.5.4 A temperature of the water at the inlet: not higher than +25°C

5. After service

We offer one year's free repair to the equipment according to the warranty card. The repair of the equipment should be carried out by our professional technician. We are not responsible for any irretrievable damage caused by the non-professional person.

6. Symbol instruction



Trademark

IPX0 Ordinary equipment

 Alternating current

IPX1 Drip-proof

 Date of manufacture

 Manufacturer

 Class II equipment

 Type BF applied part

 Foot switch interface

 Used indoor only

 Adjustment for the water flow

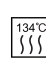
 Can be autoclaved

~24V 24VAC power supply socket

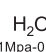
 Water entrance pressure
0.01MPa-0.5MPa

 0197 CE marked product

 FDA marked product



Consult the accompanying documents



Appliance compliance WEEE directive



Atmospheric pressure for storage

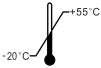

Temperature limitation
for storage



Humidity limitation for
storage



Authorised Representative in the EUROPEAN
COMMUNITY

7. Environmental protection

Please dispose according to the local laws.

8. Manufacturer's right

We reserve the right to change the design of the equipment, the technique, fittings, the instruction manual and the content of the original packing list at any time without notice. If there are some differences between blueprint and real equipment, take the real equipment as the norm.

9. European authorized representative



MedNet GmbH
Borkstrasse 10 · 48163 Muenster · Germany

10. EMC-Declaration of conformity

Guidance and manufacturer's declaration - electromagnetic emissions		
The model UDS-J, UDS-K, UDS-K LED, UDS-L, UDS-L LED, UDS-A, UDS-A LED, UDS-P, UDS-E, UDS-P LED, UDS-E LED, D1, D3, D5, D7, D3 LED, D5 LED, D7 LED are intended for use in the electromagnetic environment specified below. The customer or the user of the model UDS-J, UDS-K, UDS-K LED, UDS-L, UDS-L LED, UDS-A, UDS-A LED, UDS-P, UDS-E, UDS-P LED, UDS-E LED, D1, D3, D5, D7, D3 LED, D5 LED, D7 LED should assure that it is used in such an environment.		
Emissions test	Compliance	Electromagnetic environment - guidance
RF emissions CISPR 11	Group 1	The models UDS-J, UDS-K, UDS-K LED, UDS-L, UDS-L LED, UDS-A, UDS-A LED, UDS-P, UDS-E, UDS-P LED, UDS-E LED, D1, D3, D5, D7, D3 LED, D5 LED, D7 LED use RF energy only for its internal function. Therefore, its RF emissions are very low and are not likely to cause any interference in nearby electronic equipment.
RF emissions CISPR11	Class B	The models UDS-J, UDS-K, UDS-K LED, UDS-L, UDS-L LED, UDS-A, UDS-A LED, UDS-P, UDS-E, UDS-P LED, UDS-E LED, D1, D3, D5, D7, D3 LED, D5 LED, D7 LED are suitable for used in domestic establishment and in establishment directly connected to a low voltage power supply network which supplies buildings used for domestic purposes.
Harmonic emissions IEC 61000-3-2	Class A	
Voltage fluctuations / flicker emissions IEC 61000-3-3	Complies	

Guidance & Declaration — electromagnetic immunity			
The models UDS-J, UDS-K, UDS-K LED, UDS-L, UDS-L LED, UDS-A, UDS-A LED, UDS-P, UDS-E, UDS-P LED, UDS-E LED, D1, D3, D5, D7, D3 LED, D5 LED, D7 LED are intended for use in the electromagnetic environment specified below. The customer or the user of the models UDS-J, UDS-K, UDS-K LED, UDS-L, UDS-L LED, UDS-A, UDS-A LED, UDS-P, UDS-E, UDS-P LED, UDS-E LED, D1, D3, D5, D7, D3 LED, D5 LED, D7 LED should assure that It is used in such an environment.			
Immunity test	IEC 60601 test level	Compliance level	Electromagnetic environment - guidance
Electrostatic discharge (ESD) IEC 61000-4-2	±6 kV contact ±8 kV air	±6 kV contact ±8 kV air	Floors should be wood, concrete or ceramic tile. If floors are covered with synthetic material, the relative humidity should be at least 30 %.
Electrical fast transient/burst IEC 61000-4-4	±2kV for power supply lines ±1 kV for Input/output lines	±2kV for power supply lines ±1kV for interconnecting cable	Mains power quality should be that of a typical commercial or hospital environment.
Surge IEC 61000-4-5	±1 kV line to line ±2 kV line to earth	±1 kV line to line	Mains power quality should be that of a typical commercial or hospital environment.
Voltage dips, short interruptions and voltage variations on power supply input lines IEC 61000-4-11.	<5 % U_T (>95% dip in U_T) for 0.5 cycle 40 % U_T (60% dip in U_T) for 5 cycles 70% U_T (30% dip in U_T) for 25 cycles <5% U_T (>95 % dip in U_T) for 5 sec	<5 % U_T (>95% dip in U_T) for 0.5 cycle 40 % U_T (60% dip in U_T) for 5 cycles 70% U_T (30% dip in U_T) for 25 cycles <5% U_T (>95 % dip in U_T) for 5 sec	Mains power quality should be that of a typical commercial or hospital environment. If the user of the models UDS-J, UDS-K, UDS-K LED, UDS-L, UDS-L LED, UDS-A, UDS-A LED, UDS-P, UDS-E, UDS-P LED, UDS-E LED, D1, D3, D5, D7, D3 LED, D5 LED, D7 LED require continued operation during power mains interruptions, it is recommended that the models UDS-J, UDS-K, UDS-K LED, UDS-L, UDS-L LED, UDS-A, UDS-A LED, UDS-P, UDS-E, UDS-P LED, UDS-E LED, D1, D3, D5, D7, D3 LED, D5 LED, D7 LED be powered from an uninterruptible power supply or a battery.
Power frequency (50/60 Hz) magnetic field IEC 61000-4-8	3 A/m	3 A/m	Power frequency magnetic fields should be at levels characteristic of a typical location in a typical commercial or hospital environment.

NOTE U_T is the a.c. mains voltage prior to application of the test level.

Guidance & Declaration - Electromagnetic immunity

The models UDS-J, UDS-K, UDS-K LED, UDS-L, UDS-L LED, UDS-A, UDS-A LED, UDS-P, UDS-E, UDS-P LED, UDS-E LED, D1, D3, D5, D7, D3 LED, D5 LED, D7 LED are intended for use in the electromagnetic environment specified below. The customer or the user of the models UDS-J, UDS-K, UDS-K LED, UDS-L, UDS-L LED, UDS-A, UDS-A LED, UDS-P, UDS-E, UDS-P LED, UDS-E LED, D1, D3, D5, D7, D3 LED, D5 LED, D7 LED should assure that it is used in such an environment.

Immunity test	IEC 60601 test level	Compliance level	Electromagnetic environment - guidance
Conducted RF IEC 61000-4-6 Radiated RF IEC 61000-4-3	3 Vrms 150 kHz to 80 MHz 3 V/m 80 MHz to 2.5 GHz	3V 3 V/m	Portable and mobile RF communications equipment should be used no closer to any part of the models UDS-J, UDS-K, UDS-K LED, UDS-L, UDS-L LED, UDS-A, UDS-A LED, UDS-P, UDS-E, UDS-P LED, UDS-E LED, D1, D3, D5, D7, D3 LED, D5 LED, D7 LED, including cables, than the recommended separation distance calculated from the equation applicable to the frequency of the transmitter. Recommended separation distance 3V $d=1.2 \times P^{1/2}$ 80 MHz to 800 MHz $d=2.3 \times P$ 800 MHz to 2.5 GHz where P is the maximum output power rating of the transmitter in watts (W) according to the transmitter manufacturer and d is the recommended separation distance in meters (m). Field strengths from fixed RF transmitters, as determined by an electromagnetic site survey, ^a should be less than the compliance level in each frequency range. ^b Interference may occur in the vicinity of equipment marked with the following symbol: 

NOTE 1 At 80 MHz end 800 MHz, the higher frequency range applies.

NOTE 2 These guidelines may not apply in all situations. Electromagnetic propagation is affected by absorption and reflection from structures, objects and people.

^a Field strengths from fixed transmitters, such as base stations for radio (cellular/cordless) telephones and land mobile radios, amateur radio, AM and FM radio broadcast and TV broadcast cannot be predicted theoretically with accuracy. To assess the electromagnetic environment due to fixed RF transmitters, an electromagnetic site survey should be considered. If the measured field strength in the location in which the models UDS-J, UDS-K, UDS-K LED, UDS-L, UDS-L LED, UDS-A, UDS-A LED, UDS-P, UDS-E, UDS-P LED, UDS-E LED, D1, D3, D5, D7, D3 LED, D5 LED, D7 LED are used exceeds the applicable RF compliance level above, the model UDS-J, UDS-K, UDS-K LED, UDS-L, UDS-L LED, UDS-A, UDS-A LED, UDS-P, UDS-E, UDS-P LED, UDS-E LED, D1, D3, D5, D7, D3 LED, D5 LED, D7 LED should be observed to verify normal operation. If abnormal performance is observed, additional measures may be necessary, such as reorienting or relocating the models UDS-J, UDS-K, UDS-K LED, UDS-L, UDS-L LED, UDS-A, UDS-A LED, UDS-P, UDS-E, UDS-P LED, UDS-E LED, D1, D3, D5, D7, D3 LED, D5 LED, D7 LED.

^b Over the frequency range 150 kHz to 80 MHz, field strengths should be less than 3V/m.

Recommended separation distances between portable and mobile RF communications equipment and the models UDS-J, UDS-K, UDS-K LED, UDS-L, UDS-L LED, UDS-A, UDS-A LED, UDS-P, UDS-E, UDS-P LED, UDS-E LED, D1, D3, D5, D7, D3 LED, D5 LED, D7 LED			
The model UDS-J, UDS-K, UDS-K LED, UDS-L, UDS-L LED, UDS-A, UDS-A LED, UDS-P, UDS-E, UDS-P LED, UDS-E LED, D1, D3, D5, D7, D3 LED, D5 LED, D7 LED is intended for use in electromagnetic environment in which radiated RF disturbances is controlled. The customer or the user of the models UDS-J, UDS-K, UDS-K LED, UDS-L, UDS-L LED, UDS-A, UDS-A LED, UDS-P, UDS-E, UDS-P LED, UDS-E LED, D1, D3, D5, D7, D3 LED, D5 LED, D7 LED can help prevent electromagnetic interference by maintaining a minimum distance between portable and mobile RF communications equipment (transmitters) and the models UDS-J, UDS-K, UDS-K LED, UDS-L, UDS-L LED, UDS-A, UDS-A LED, UDS-P, UDS-E, UDS-P LED, UDS-E LED, D1, D3, D5, D7, D3 LED, D5 LED, D7 LED are recommended below, according to the maximum output power of the communications equipment.			
Rated maximum output power of transmitter W	Separation distance according to frequency m		
	150kHz to 80MHz $d=1.2 \times P^{1/2}$	80MHz to 800MHz $d=1.2 \times P^{1/2}$	800MHz to 2,5GHz $d=2.3 \times P^{1/2}$
0,01	0.12	0.12	0.23
0,1	0.38	0.38	0.73
1	1.2	1.2	2.3
10	3.8	3.8	7.3
100	12	12	23
For transmitters rated at a maximum output power not listed above, the recommended separation distance d in meters (m) can be estimated using the equation applicable to the frequency of the transmitter, where P is the maximum output power rating of the transmitter in watts (W) accordable to the transmitter manufacturer.			
NOTE 1 At 80 MHz and 800 MHz. the separation distance for the higher frequency range applies.			
NOTE 2 These guidelines may not apply in all situations. Electromagnetic propagation is affected by absorption and reflection from structures, objects and people.			

The device has been tested and homologated in accordance with EN 60601-1-2 for EMC. This does not guarantee in any way that this device will not be effected by electromagnetic interference Avoid using the device in high electromagnetic environment.

11. Statement

All rights of modifying the product are reserved to the manufacturer without further notice. The pictures are only for reference. The final interpretation rights belong to GUILIN WOODPECKER MEDICAL INSTRUMENT CO., LTD. The industrial design, inner structure, etc, have claimed for several patents by WOODPECKER, any copy or fake product must take legal responsibilities.

TABLE OF OPERATING POWER OF THE TIPS

Scaling	
Tip Model	Power
G 1	1-10(G)
G 2	1-10(G)
G 3	1-10(G)
G 4	1-10(G)
G 5	1-10(G)
G 6	1-10(G)
G 7	1-10(G)
G 8	1-10(G)
G 9	1-10(G)
G 10	1-10(G)
G 11	1-10(G)

Periodontics	
Tip Model	Power
P1	1-10(P)
P2L	1-3(P)
P2LD	1-2(P)
P2R	1-3(P)
P2RD	1-2(P)
P3	1-6(P)
P3D	1-6(P)
P4	1-6(P)
P4D	1-6(P)

Endodontics	
Tip Model	Power
E1	1-3(E)
E2	1-3(E)
E3	1-6(E)
E3D	1-3(E)
E4	1-6(E)
E4D	1-3(E)
E5	1-6(E)
E5D	1-3(E)
E8	1-10(E)
E9	1-10(E)
E10	1-6(E)
E10D	1-6(E)
E11	1-6(E)
E11D	1-6(E)
E14	1-3(E)
E15	1-3(E)

Cavity Preparation	
Tip Model	Power
SB1	1-10(P)
SB2	1-10(P)
SB3	1-10(P)
SBL	1-10(P)
SBR	1-10(P)

Scan and Login website
for more information



Guilin Woodpecker Medical Instrument Co., Ltd.
Information Industrial Park, Guilin National High-Tech
Zone, Guilin, Guangxi, 541004 P. R. China

Tel:

Europe Sales Dept.: +86-773-5873196, +86-773-2125222

North America, South America &

Oceania Sales Dept.: +86-773-5873198, +86-773-2125123

Asia & Africa Sales Dept.: +86-773-5855350, +86-773-2125896

Fax: +86-773-5822450

E-mail: woodpecker@glwoodpecker.com, sales@glwoodpecker.com

Website: <http://www.glwoodpecker.com>



MedNet GmbH

Borkstrasse 10 · 48163 Muenster · Germany